

## Lutron Ecosystem Wall Station Operation

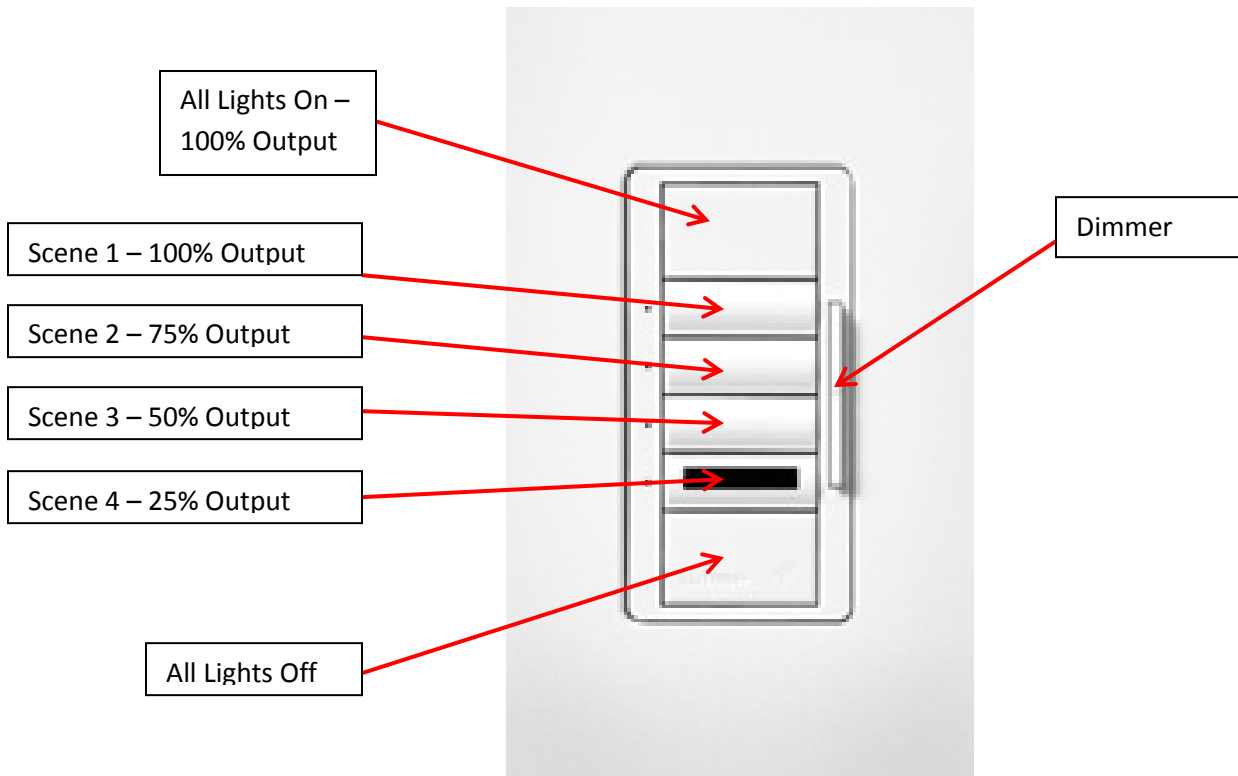

All Tenant lights located within 15 feet of any perimeter windows are controlled by a daylight sensor that will dim the lights in relation to the natural light available. The daylight sensor establishes a maximum light level that cannot be exceeded. Wall Switches allow occupants to dim lights in offices and specialty areas below the maximum level, but light levels cannot be increased above the default maximum light level.

For example, if the daylight sensor calls for a maximum light output of 75%, then there will be no noticeable difference between Scene 1 – 100% Output and Scene 2 – 75% Output, since the maximum allowable light output is set at 75%. Tenants can, however, reduce light levels below the maximum allowable light level by selecting a scene with a lower light output.

The buttons cannot be individually programmed, but the dimmer switch on the right side of the wall station can be used to choose a light level that is different from one of the programmed scenes. For more information about the Lutron lighting system, please visit the Lighting page on the Duke Energy Center website <http://www.dukeenergycenter.info/lighting.aspx>.